



VINCISMILE GROUP LLC

Add: 20524 Carrey Rd. Walnut, CA 91789, USA

Email: marketing@vincismile.com

www.vincismile.com



Follow @VinciSmile

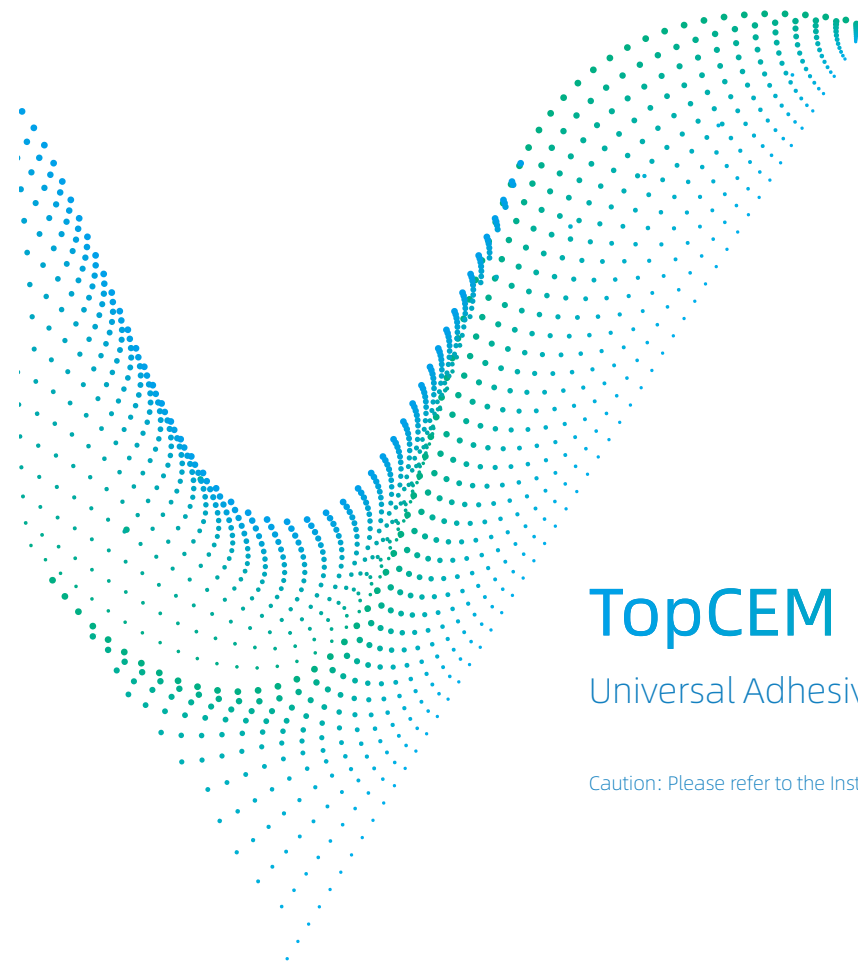

TopCEM Elite System

Universal Adhesive Cementation Solution

Caution: Please refer to the Instructions for Use first.

· INDICATION ·

TopCEM Elite System is designed for cementation of all sorts of dental restorations including crowns, bridges, inlays/onlays, veneers, dental posts and other restorations, which are made of metals/alloys, metal-ceramic, all ceramic, oxide-ceramic(zirconia), glass ceramic, composite and their combinations.



Inlay



Onlay



Crown



Bridge



Maryland Bridge



Fiber Post



Implant Crown



Veneer

CEMENTATION PROCEDURE OF BRISGES, INLAYS, ONLAYS, VENEERS.

1. Preparation/Pre-treatment of restorations:

1.1 Glass-ceramic restorations



Apply **HF-Etchant**, wait for 60 seconds.



Rinse thoroughly with water for 10 seconds.



Dry with oil-free air.

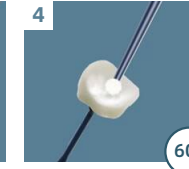

Apply **TopCEM Ceramic Primer**, wait for 60 seconds.



Dry the coupling agent with air.

*DO NOT TOUCH THE RESTORATION SURFACE WITH YOUR HANDS

1.2 Metals, Zirconia and Aluminium Oxide restorations

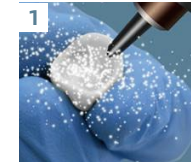

Sandblast the surfaces to be cemented.



Clean the blasted surface with alcohol or water.



Dry it with oil-free air.

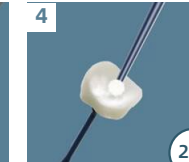

Apply **HugeBond Universal Flippro*** to the inner surface, rub it in for 20 seconds.



Dry with oil-free air for 10 seconds.

*Or **TopCEM Ceramic Primer**

*DO NOT LIGHT CURE THE ADHESIVE ON THE RESTORATION SURFACE.

CEMENTATION PROCEDURE OF BRISGES, INLAYS, ONLAYS, VENEERS.

2. Preparation/Pre-treatment of teeth



Clean the tooth to be cemented, rinse with water



Lightly air dry, or use cotton pellets to dry it off.

DO NOT OVER DRY.

Isolate the teeth with rubber dam.

[OPTIONAL]



Apply **P-Etchant** to both enamel and dentin surface (Total etch) or to enamel surface only (Selective etch).



Rinse the surfaces thoroughly for 10 seconds with water. With a stream of water (0.2 -0.4 MPa pressure) while using suction tube to dry the field simultaneously.



Dry lightly the tooth surface afterwards.



Clean and dry the tooth surface with oil-free air for 2-3 seconds. **DO NOT OVER DRY.**



Apply **HugeBond Universal Flippro** to the tooth surface, rub it in for 20 seconds evenly to ensure a shiny surface.



Air dry for 10-15 seconds. (Use a gentle stream of air to remove solvent in the adhesive. If surface shine disappears after drying, re-apply the adhesive and re-dry.)



Light cure tooth for 10 seconds. (with an output of >800mw/cm2 light source)

CEMENTATION PROCEDURE OF BRISGES, INLAYS, ONLAYS, VENEERS.

3. Cementation of restorations



Place 1:1 mixed Dual Cure Resin Cement onto the primed surface.



Seat the restoration on the tooth in position.



Light cure the excess cement from the margin for 2 seconds, then clean the excess material.



Light cure each side for 10s, or wait for 4.5 minutes.



Finish and polish, adjust the occlusal.

CEMENTATION PROCEDURE OF FIBER POST

1. Preparation/Pre-treatment for restorations

1. Posts made from Fiber composite, ceramic or metal

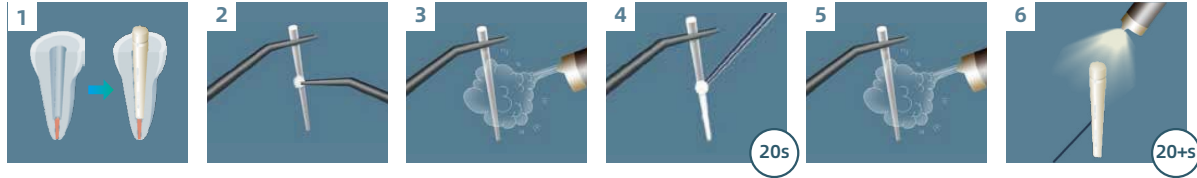

Prepare the root and try the post according to the corresponding Instruction of Use.

Clean up the fiber post with alcohol.

Dry with oil-free air.

Apply **HugeBond Universal Flipro** to the fiber post, rub it in for 20 seconds.

Dry with oil-free air.

Light cure the post for at least 20 seconds.

2. Preparation/Pre-treatment for root canals

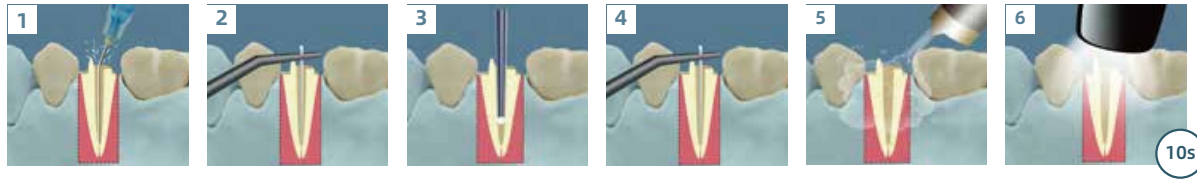

Clean the root canals with distilled water or sodium hypochlorite (NaOCl) .

Clean and dry with paper tips.

Apply **HugeBond Universal Flipro** to the root canal, rub it in for 20 seconds.

Absorb the excess adhesive with paper tips or cotton swab.

Dry with oil-free air.

Light cure the root canal for 10 seconds

CEMENTATION PROCEDURE OF FIBER POST

3. Cementation of Fiber Post

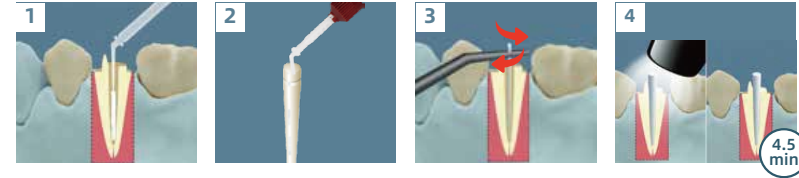

Fill enough amount of **TopCEM** into the root canal.

Apply additional cement to the post.

Seat the post into the root canal.

Light cure for 10 seconds and wait for 4.5 minutes for the cement to set.

CEMENTATION PROCEDURE OF SCREW RETAINED CROWN IN LAB SIDE

1. Preparation/Pre-treatment of restorations

1.Crowns made from zirconia,metal-ceramic

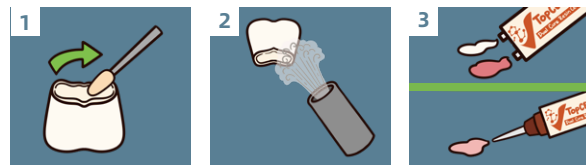

1
Apply TopCEM
Ceramic Primer to
the inner surface.

2
Dry with oil-free air
to remove the
solvent.

3
TopCEM prepared.

2. Cementation of Implant Crown



1
Apply the cement
to coat the surface
with brush.

2
Seat the crown to
the abutment.

3
Light cure the
excess cement in
the margin for 2
seconds, remove
and clean.

4
Light cure each side
for 10s, or wait for
4.5minutes.

HugeBond Universal FliPro

Light Cure Dental Adhesive

Universal
Reliable



Indication

- Direct bonding under a light-cured composite or compomer fillings.
- Repair of dental restorations of ceramic, composites and metal alloys.
- Indirect dental restorations cementation with resin cement.
- Seal hypersensitive areas of teeth.

8TH
GENERATION

TopCEM

Dual Cure Resin Cement

Indication

- Cementation of all sorts of dental restorations including crowns, bridges, inlays/onlays, veneers, dental posts and other restorations made from materials of metals/alloys, metal-ceramic, all-ceramic and/or porcelain, composites, and their combinations.



Technical Parameters

· Working and Setting time of TopCEM Dual Cure Resin Cement

| | Times and conditions |
|--|---|
| Working time | > 60 seconds at room temperature (23°C) |
| Setting time (including working time) | ≤ 4.5 minutes intraorally (37°C) |

· Light Cure Time and Output

| Light cure time | Light output |
|-----------------|---------------------------------------|
| 20 seconds | Light output < 800 mw/cm ² |
| 10 seconds | Light output > 800 mw/cm ² |

· CAUTION ·

For dental use only. Do not use for indications or applications that are not specifically noted in the instructions for use.

Follow the Operating Procedures when using.